



SAFARI V-SPEC SNORKEL

SS181HF

30/01/04

ITEM	DESCRIPTION	QTY	PART NO
1	BODY – SNORKEL	1	390-133-200
2	3½ " AIR RAM ASSEMBLY	1	000-135-800
3	DUCT – INNER	1	390-124-200
4	BRACKET – UPPER MOUNTING	1	390-032-200
5	BOLT – HEX 6mm x 1.0mm x 14m	3	000-002-100
6	SCREW – S/T – 4.2mm x 13mm	4	000-951
7	BODY CLIP – PLASTIC	4	000-960
8	STUD – S/S 8mm x 1.25mm x 25mm – O.L.	5	000-110
9	WASHER – BODY – 8mm x 30mm	5	000-311-300
10	NUT – NYLOC – 8mm x 1.25mm	5	000-205-300
11	HOSE – RUBBER – 90mmID x 36mm	1	000-807-142E
12	HOSE – RUBBER – 95mmID x 52mm	1	000-830-205E
13	CLAMP – HOSE 80/100mm	2	000-909
14	TEMPLATE	1	390-017-200
15	HOSE CLAMP - SIZE 56 (BLACK)	1	000-914/B
16	CLAMP – HOSE 90/110mm	2	000-910

WARNING!!

**IT IS AN INSTALLER
RESPONSIBILITY TO VERIFY
ALL COMPONENTS, AND
PARTICULARLY THE
TEMPLATE ARE CORRECT,
BEFORE STARTING ANY PART
OF THE SNORKEL
INSTALLATION.**

**(CHECK TEMPLATE AGAINST
SNORKEL BODY)**



SAFARI V-SPEC SNORKEL

SS181HF

**To Suit: TOYOTA LANDCRUISER PRADO 120 SERIES
3.0L 4 Cyl TDi (1KZ-TE & 1KD-FTV Engines)**

Fitment to: Right hand side
Fitting time: Approximately 120 minutes
Special Tools: 95mm holesaw
8mm drill bit
16mm drill bit
Step drill

Instructions:

1. Remove : Air cleaner assembly
: Right hand front wheel arch liner
: Air intake ducting
2. Tape the template to the upper rear corner of the right hand guard. Using a felt tip pen, mark all hole positions. Remove template.
3. Drill a pilot hole for each hole position. Using the step drill, drill the 3 lower mounting hole positions to 16mm. Using the 16mm drill bit, drill the 2 upper mounting hole positions to 16mm. Using the 95mm holesaw, drill the main hole position. Deburr and paint all holes.

NEW ZEALAND INSTALLATIONS ONLY :

Safari have developed 2 methods of Snorkel A pillar attachment, for the conventional method please proceed with the current document alternatively please see the link below for further instructions.

www.safari4x4.co.nz/apillarmounting

4. Screw the 5 mounting studs into the snorkel body inserts, fasten the upper mounting bracket to the snorkel body using necessary hardware. Carefully position the snorkel body onto the guard, with the snorkel body correctly positioned on the guard, mark the position of the upper mounting bracket on the 'A' pillar. Remove the snorkel body from the vehicle.
5. Remove the bracket from the snorkel body, place the bracket onto the 'A' pillar. With the bracket correctly positioned, mark the 4 mounting hole positions, drill a pilot hole for each marked hole position. Using the 8mm drill bit, drill the 4 holes. Deburr and paint holes.
6. Insert plastic body clips into the 'A' pillar, fasten the upper mounting bracket to the 'A' pillar using necessary hardware.
7. Install the inner duct into position, with the inner duct in position install the hose (Item No. 11) and hose clamps to the inner duct, with the inner duct, hose and hose clamps correctly positioned, install the snorkel body onto the guard. With the snorkel body correctly positioned, fasten using necessary hardware, fasten upper mounting bracket to the snorkel body.
8. Remove the lugs top and bottom of the air cleaner housing entry, position the hose (Item No. 12) and hose clamp to the inner duct, with the hose and hose clamps in position, install the air cleaner housing into position and fasten.
9. Fasten the connection between the snorkel body and inner duct, ensuring the inner duct is correctly positioned hard up against the snorkel body snout, fasten the hose clamps, ensure the hose is correctly positioned onto the air cleaner housing entry and the inner duct and fasten hose clamps.
10. Install air ram assembly to the snorkel body and fasten hose clamp.
11. Re-install inner guard liner.

N.B.: It is the installer's responsibility to ensure all connections are water tight.

SAFARI

4X4 ENGINEERING

SS181HF

TOYOTA LANDCRUISER PRADO 120 SERIES (1KZ-TE ENGINE)

SAFARI SNORKEL

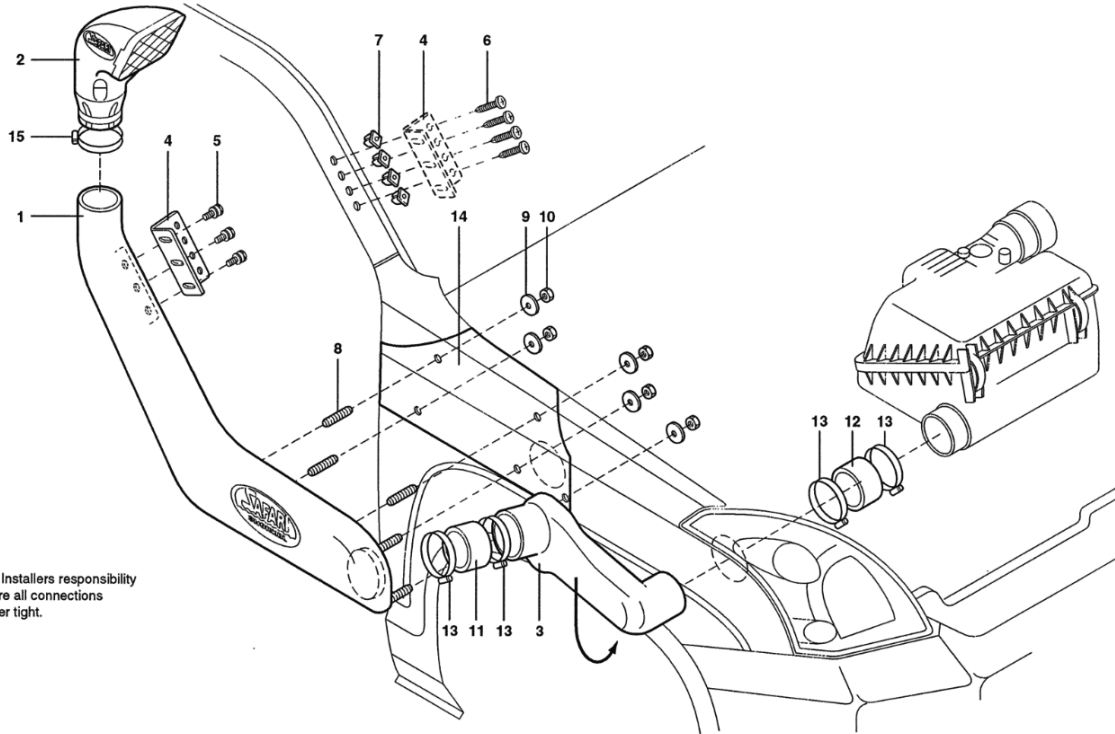

NOTE:
It is the Installers responsibility
to ensure all connections
are water tight.