



4X4 ENGINEERING

SFFVDJ70RH

TOYOTA LANDCRUISER 70 SERIES VDJ MODELS

2007 – CURRENT



CONTENTS

- **PAGE 3** - MOUNTING THE SAFARI PRE-FILTER
- **PAGE 7** - MOUNTING THE SAFARI PRE-FILTER WITH AN ARMAX ECU KIT
- **PAGE 9** - HOSE ROUTING AND CONNECTIONS
- **PAGE 14** - FUEL SYSTEM BLEEDING

Parts List

ITEM	PART NO	DESCRIPTION	QTY
1	000-075-251	FUEL PRE FILTER - 250 - ASSEMBLY	1
2	333-080-200	HOSE - FUEL - 70 SERIES - RH - KIT	1
3	333-079-100	BRACKET - STEEL - FUEL PRE FILTER - MAIN - RH	1
4	333-079-150	BRACKET - STEEL - FUEL PRE FILTER - SUPPORT - RH	1
5	010-015-035	BOLT - HEX - M10 X 1.5 X 35MM	2
6	000-309	WASHER - SPRING - M10	2
7	000-303	WASHER - FLAT - M10 X 20MM OD	2
8	000-1013-400	BOLT - HEX - M8 X 1.25 X 25MM SS SEMS	1
9	000-916-018	CLAMP - EFI - 18MM	2
10	333-083-100	LOOM - SENSOR - WATER - RH - 250	1
11	000-987-290	CABLE TIE - PLASTIC - 280MM	15

STAND ALONE FUEL FILTER SYSTEM

1

Remove air box assembly from vehicle.



2

Remove and retain bolts

Remove the three power steering reservoir mounting bolts and retain.

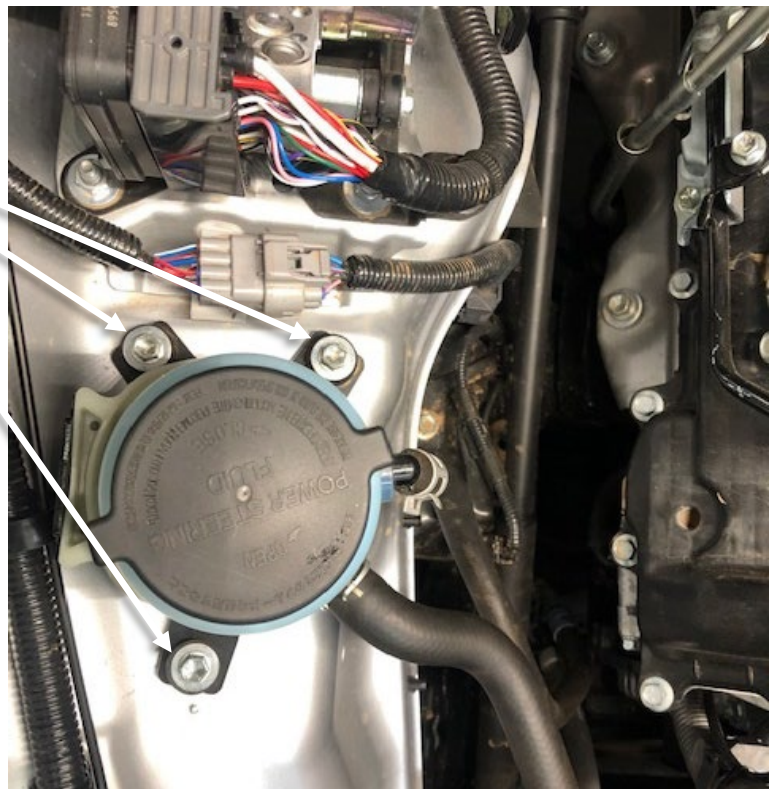
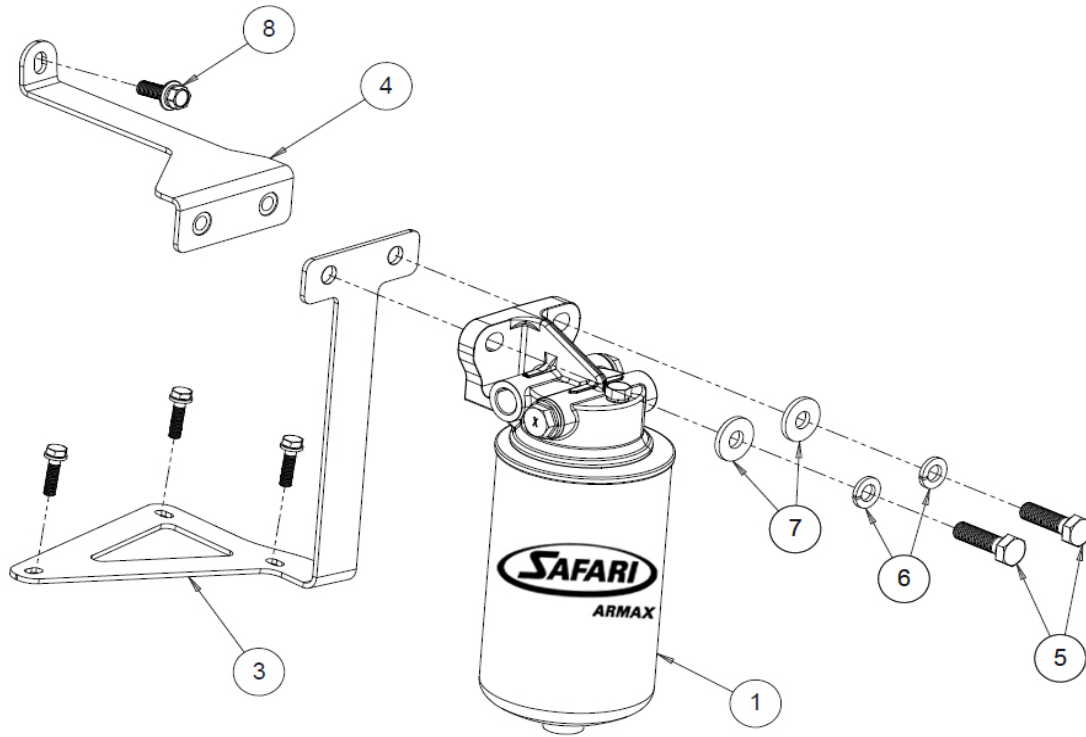
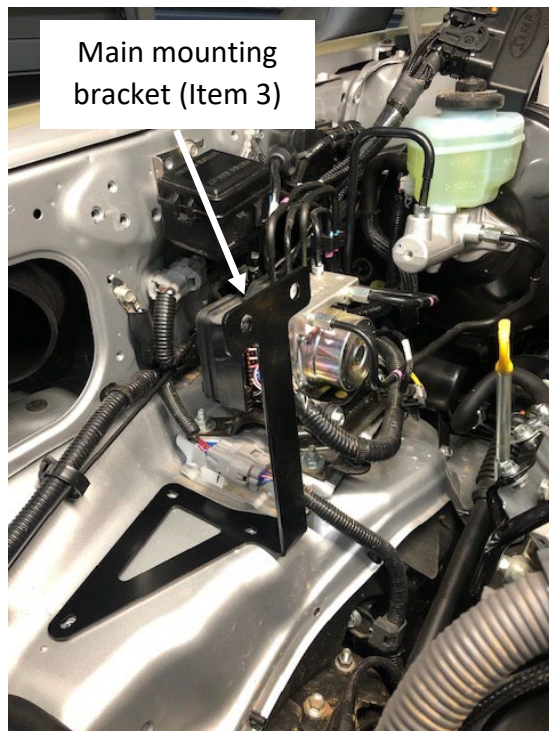

DIAGRAM OF FUEL FILTER ASSEMBLY STAND ALONE



Install the Safari fuel pre-filter main mounting bracket (Item 3).

Reinstall power steering reservoir and secure with retained mounting bolts.



Main mounting bracket (Item 3)

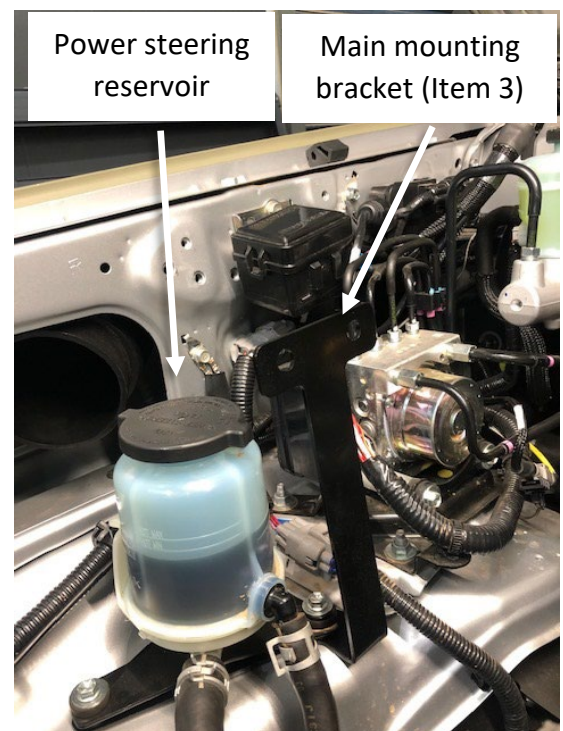

Power steering reservoir

Main mounting bracket (Item 3)

Install the Safari fuel pre-filter support mounting bracket (Item 4) to the inner guard as shown, using an M8 x 25mm bolt (Item 8).

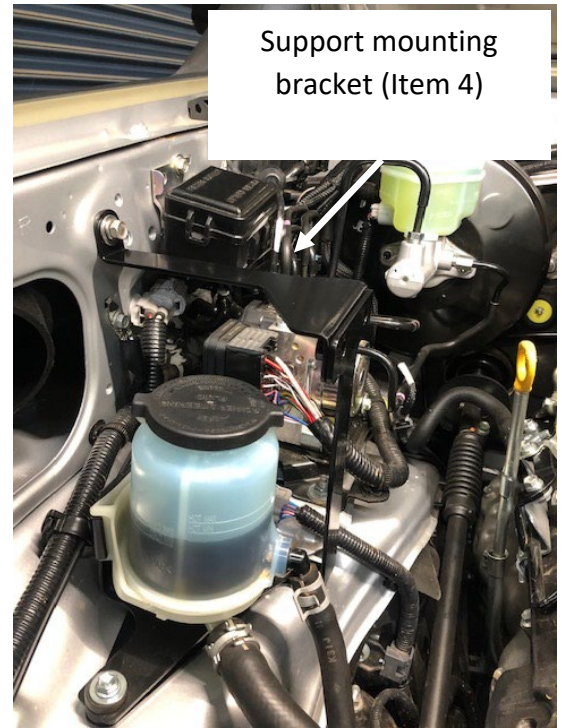
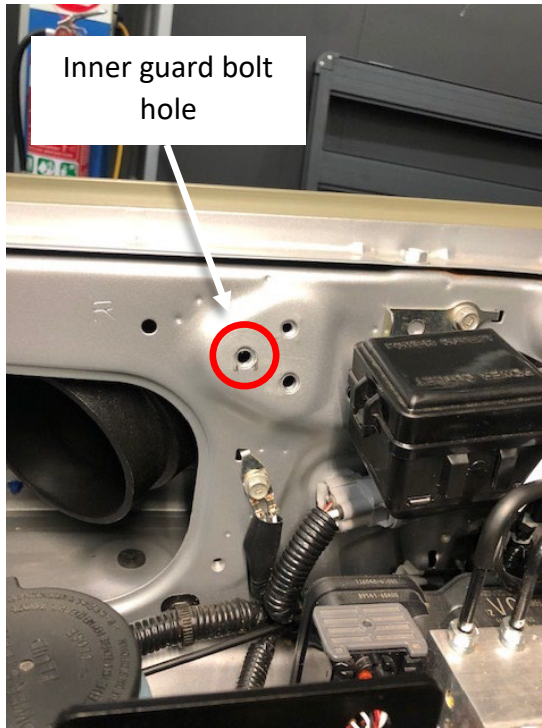

Install the adapter fittings, with copper sealing washers, into the Safari fuel pre-filter assembly as shown and tighten.

Ensure all mating surfaces are clean and the copper washers are installed.

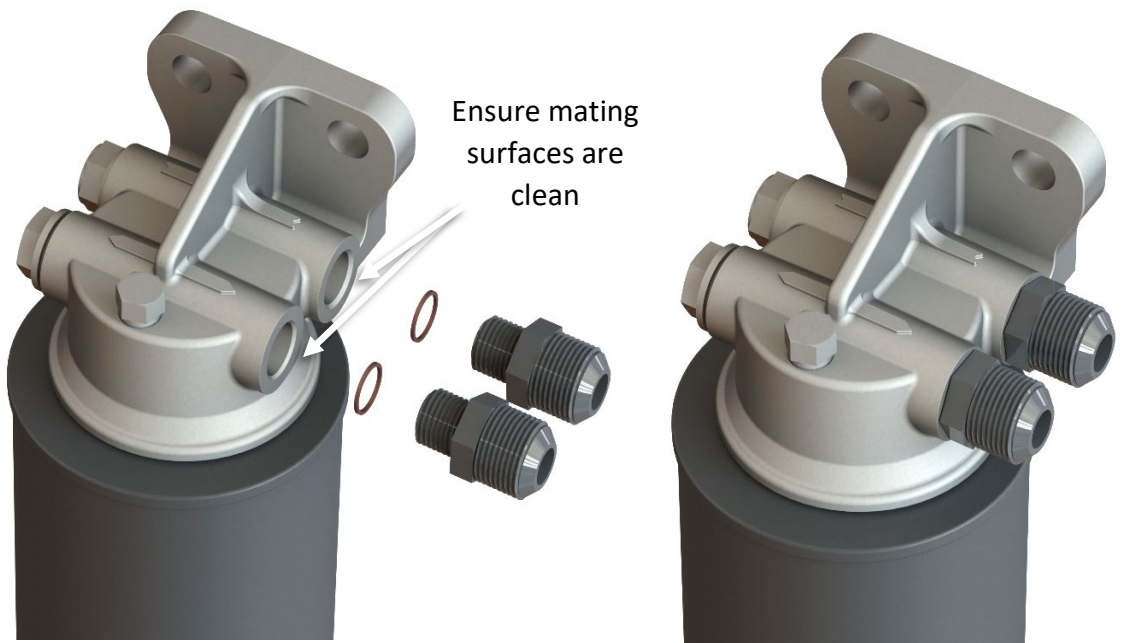

Install the Safari fuel pre-filter assembly to the mounting brackets and secure with 2x M10 x 35mm bolts (Item 5), 2x M10 spring washers (Item 6) and 2x M10 flat washers (Item 7).



Reinstall the air box assembly to the vehicle.



FOR STAND-ALONE FUEL FILTER ASSEMBLY, SKIP TO HOSE ROUTING AND CONNECTIONS SECTION - pg. 9

FUEL FILTER WITH ECU BRACKETRY

1

DIAGRAM OF FUEL FILTER ASSEMBLY WITH ECU

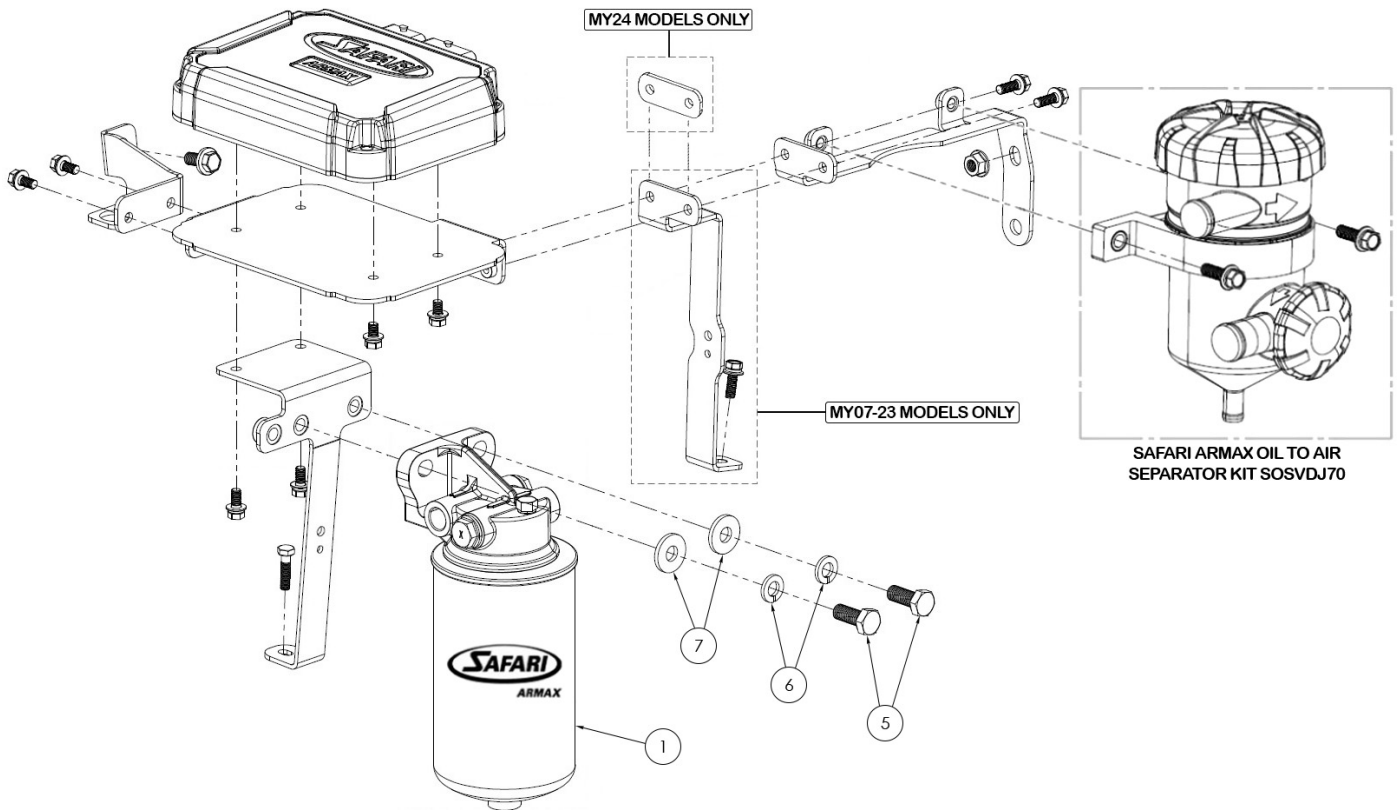

2

Disconnect the ECU header connectors.

Remove ECU mounting plate with the ECU from the vehicle.



Install the adapter fittings with copper sealing washers into the Safari fuel pre-filter assembly as shown and tighten.

Ensure all mating surfaces are clean and the copper washers are installed.

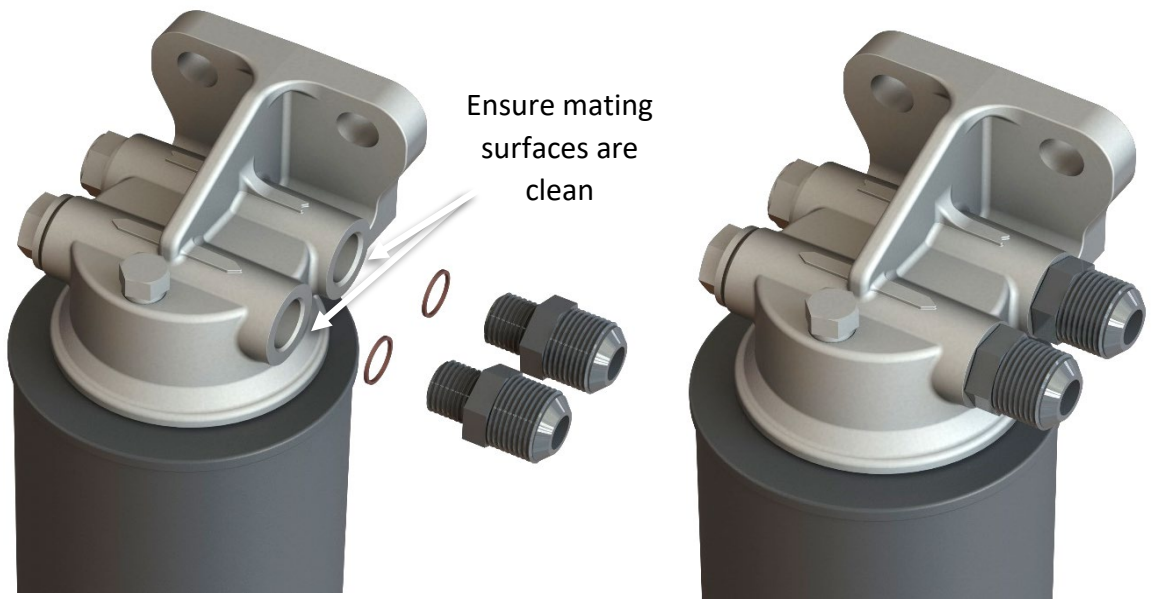

Install the Safari fuel pre-filter assembly to the mounting bracket and secure with 2x M10 x 35mm bolts (Item 5), 2x M10 spring washers (Item 6) and 2x M10 flat washers (Item 7).

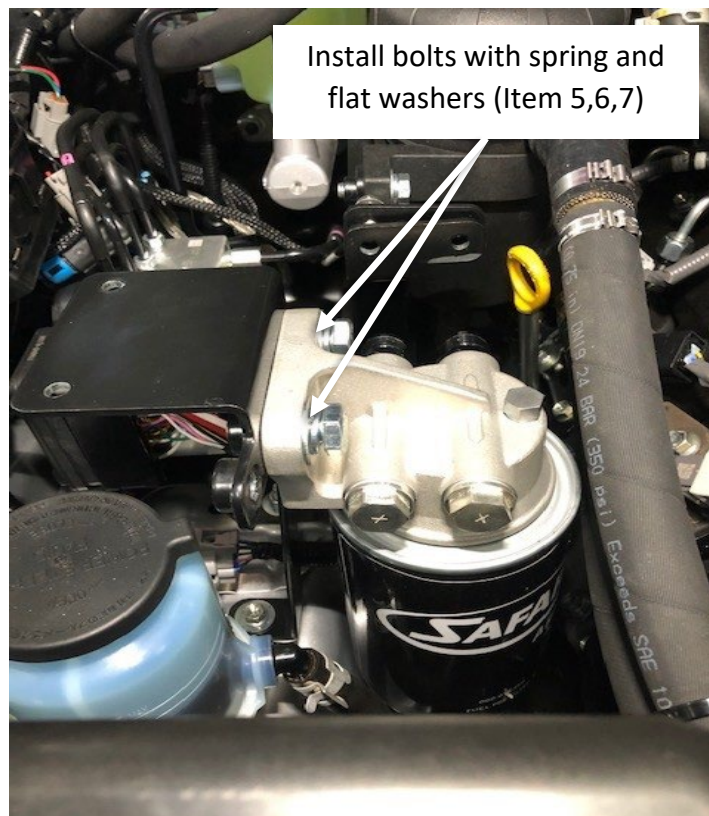

FUEL FILTER HOSE ROUTING

1

Install fuel lines (Item 2) onto the Safari fuel pre-filter and orientate as shown.



2

Route the fuel lines (Item 2) around the back of the brake booster and along the firewall to the OE fuel filter as shown.

Note: Fuel lines highlighted in red.

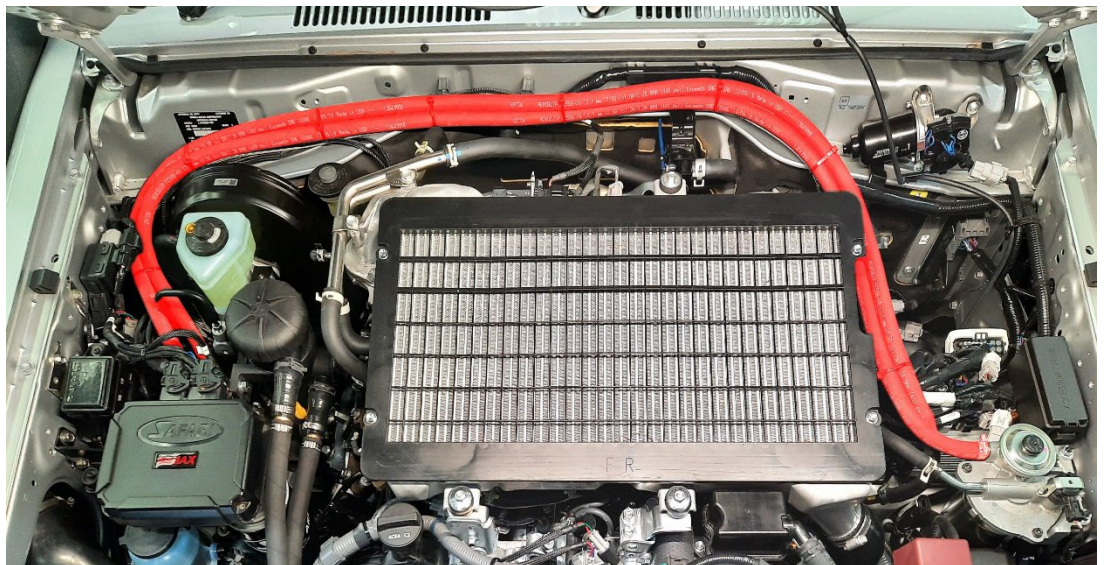

Safari fuel pre-filter hose routing.

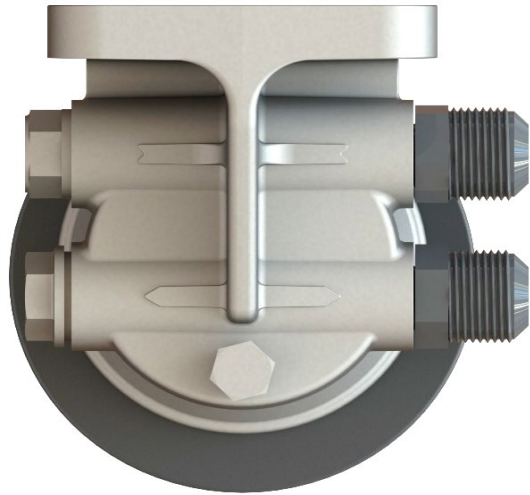

Safari pre fuel filter inlet pipe from the fuel outlet on the chassis

Safari pre fuel filter outlet to OE fuel filter inlet

Remove the fuel filter inlet hose from the OE fuel filter assembly.



Connect the Safari fuel pre-filter inlet hose with the supplied hose clamp (Item 9) to the OE fuel filter inlet pipe from the fuel tank on the chassis.

Trim hose to length and tighten hose clamp.

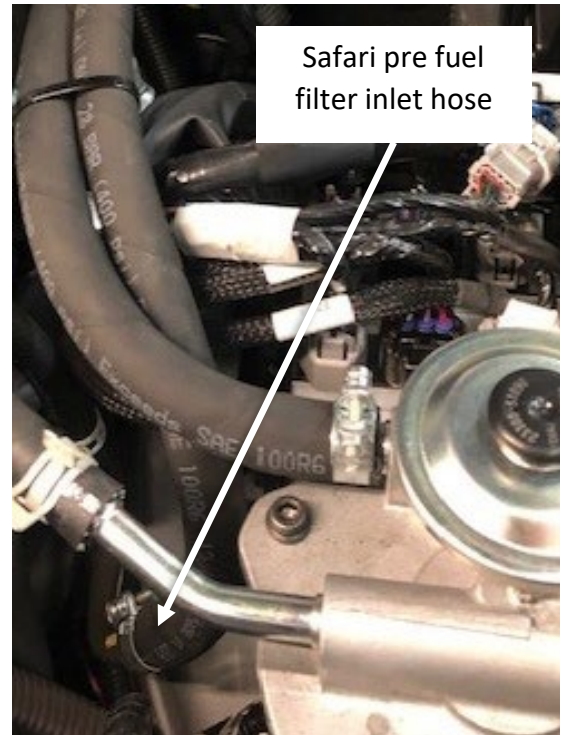
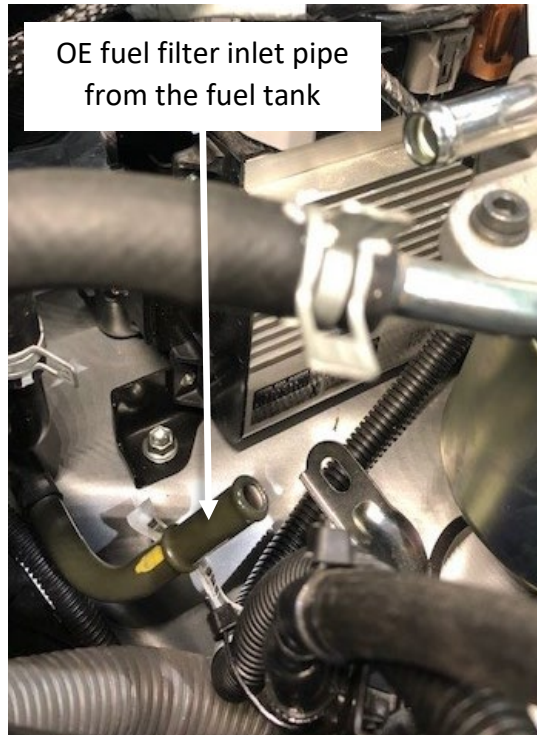

Connect the Safari fuel pre-filter outlet hose with the supplied hose clamp (Item 9) to the OE fuel filter housing inlet.

Trim hose to length and tighten hose clamp.

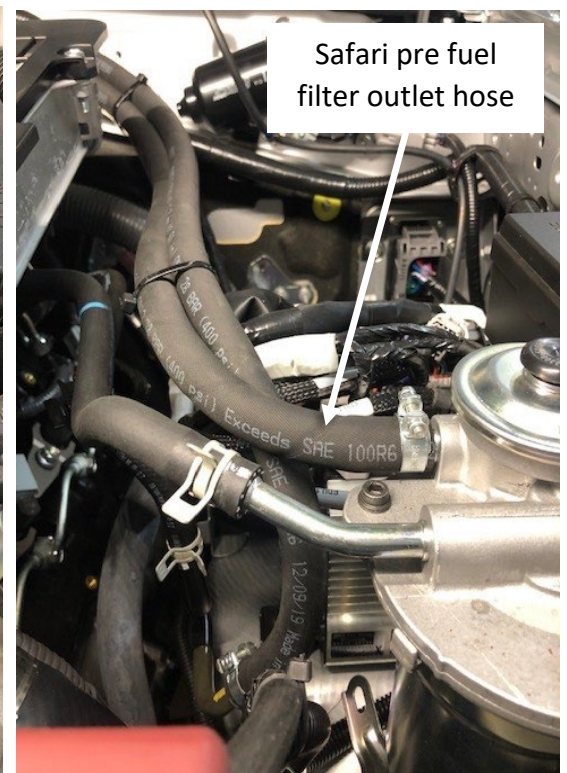

7

Remove the retaining nuts from the OE fuel filter assembly.

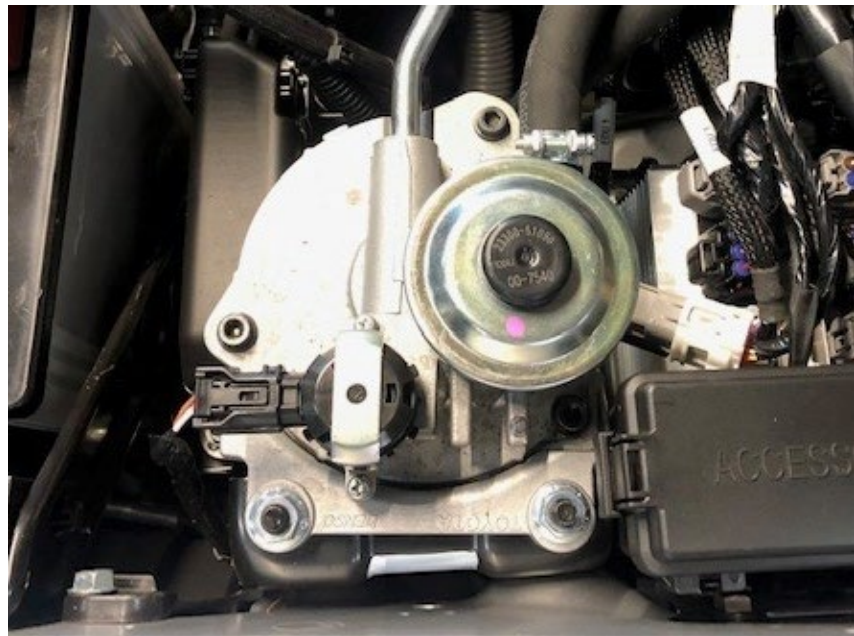

8

Lift the OE fuel filter assembly upward to access the OE water detection sensor connector.

Disconnect the sensor connector.

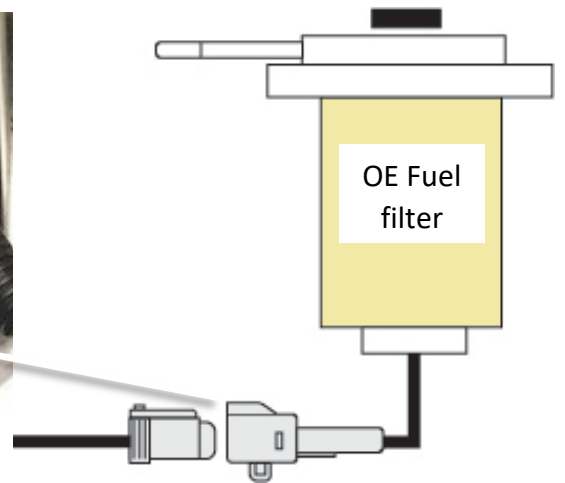

9

Install the Safari water detection harness (Item 10) to the OE connectors.

Re-install OE fuel filter assembly.

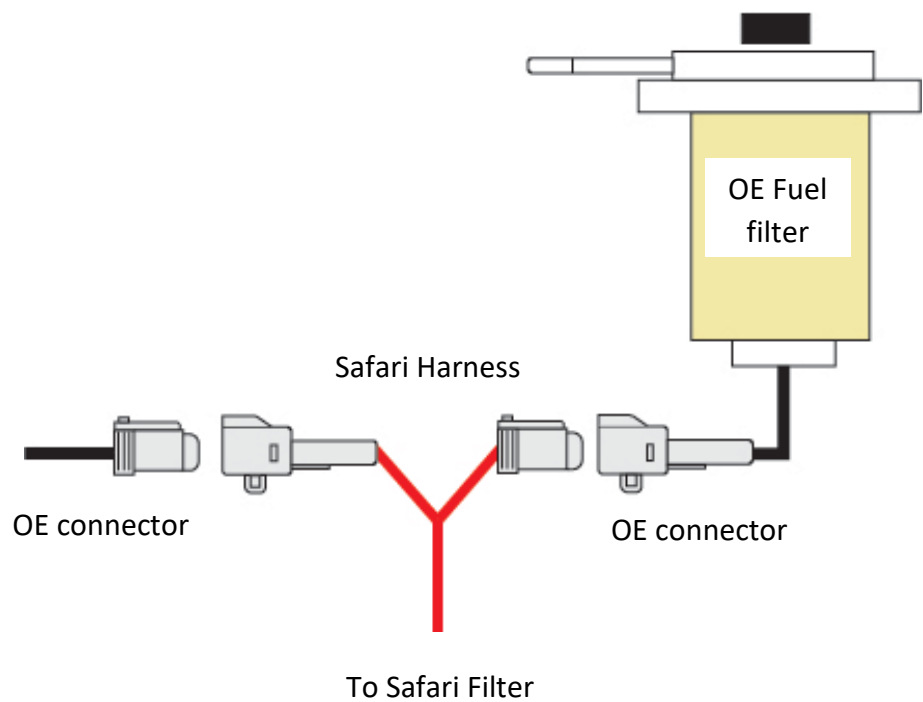

Route the single pin connector wire to the Safari Fuel pre filter along the fuel lines

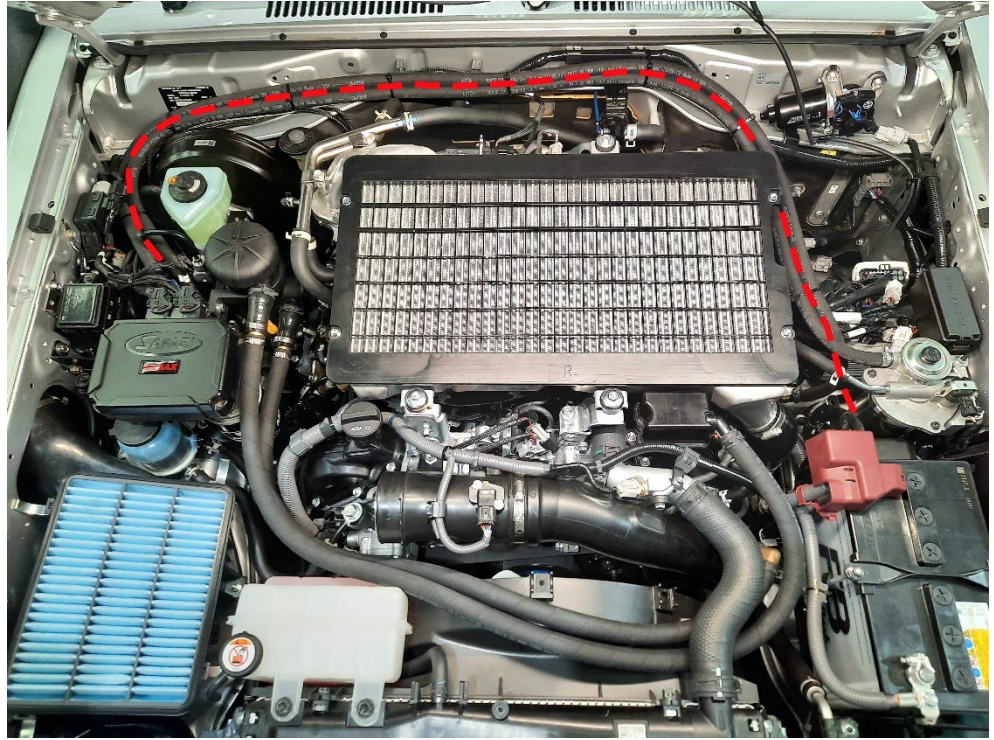

Connect the harness to the Safari filter by sliding the open end of the connector onto the water sensor.

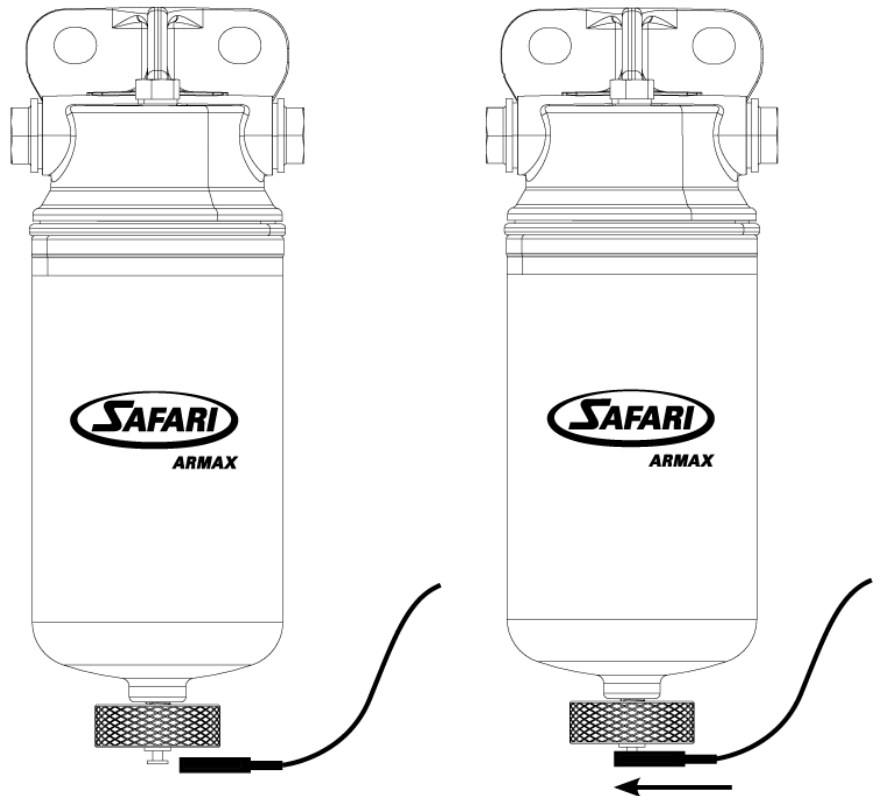

FUEL SYSTEM BLEEDING

1

Remove the Outlet hose from the OE fuel filter housing.

Using a container to catch the fuel that is pumped out of the O.E fuel filter, pump the fuel system primer until a steady stream of fuel flows into the container.

Due to the added hose length, it can take some time to prime the fuel through to the O.E fuel filter.

Note: Using an assistant to pressurise the fuel tank with compressed air will help speed up the process.

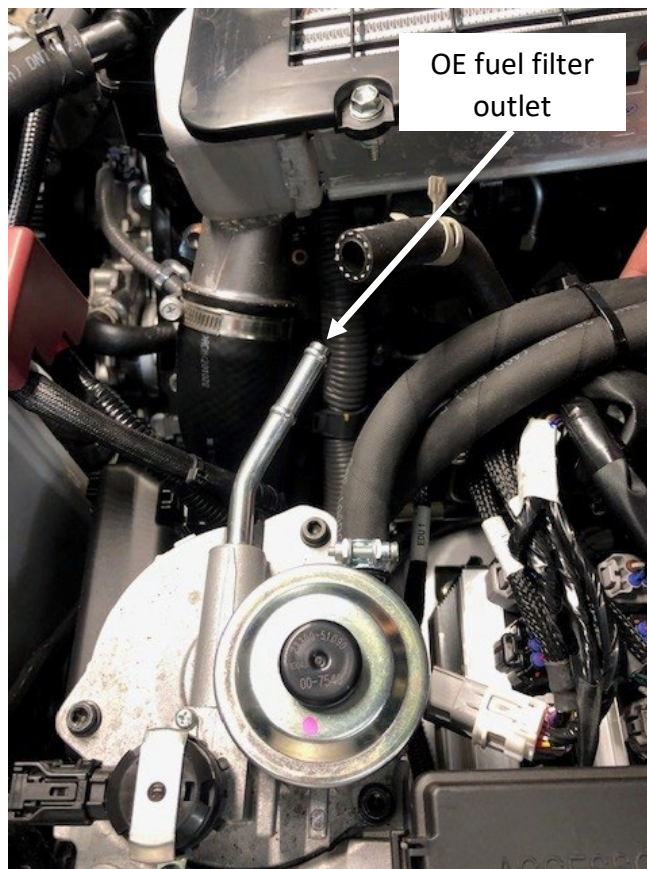

Reconnect OE fuel filter outlet hose and pump the fuel primer until firm.



- 3 Secure Safari fuel pre-filter hoses using supplied cable ties (Item 11), ensuring that the hoses are away from any hot or sharp objects.
- 4 Start vehicle and check fuel system for leaks.
- 5 Take vehicle for a road test and then recheck fuel system for leaks.
- 6 **PLACE USER MANUAL ON PASSENGER SEAT OF VEHICLE OR GIVE DIRECTLY TO THE VEHICLE OWNER.**

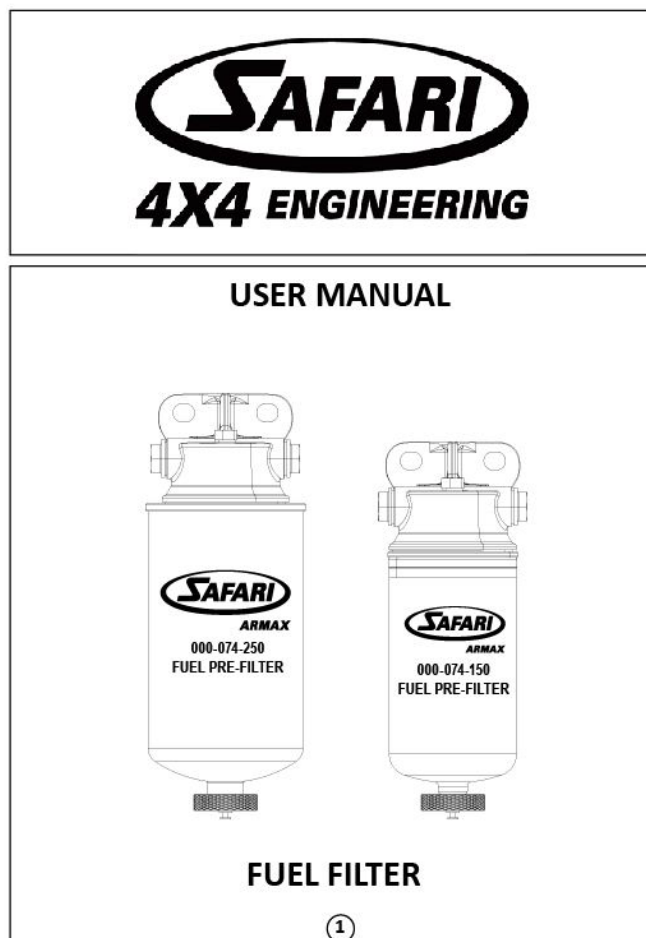

Copyright Safari 4x4 Engineering Pty Ltd Melbourne Victoria Australia – www.safari4x4.com.au